

GULLY CONNECTIONS:
 1. EACH GULLY SHALL HAVE A SEPERATE 150mm CONNECTION SURROUNDED WITH 150mm CLASS 20/20mm CONCRETE. GULLIES SHALL NOT BE INTERCONNECTED.
 2. WHEN CONNECTION TO PUBLIC SEWERS, BENDS FROM 7° UP TO 45° SHOULD BE USED AS REQUIRED AND A SADDLE JUNCTION FITTED TO MAKE THE CONNECTION TO THE SEWER. LONG RADIUS BENDS ARE PREFERRED.
 3. GULLY CONNECTIONS SHOULD NOT, IF POSSIBLE EXCEED 20m IN LENGHT AND CONNECT TO THE SEWER IN THE DIRECTION OF THE FLOW.
 4. IN UNSEALED GULLIES THE OUTLET PIPE SHALL BE 450mm ABOVE THE FLOOR OF THE GULLY PIT.
 5. WHERE THE GULLIES ARE CONNECTED TO MANHOLES, THEY SHALL BE CONNECTED AT THE BENCHING LEVEL OR A MAXIMUM OF 500mm ABOVE INVERT OF MAIN PIPE.
 6. CONNECTIONS SHALL BE TURNED WITH THE DIRECTION OF FLOW.

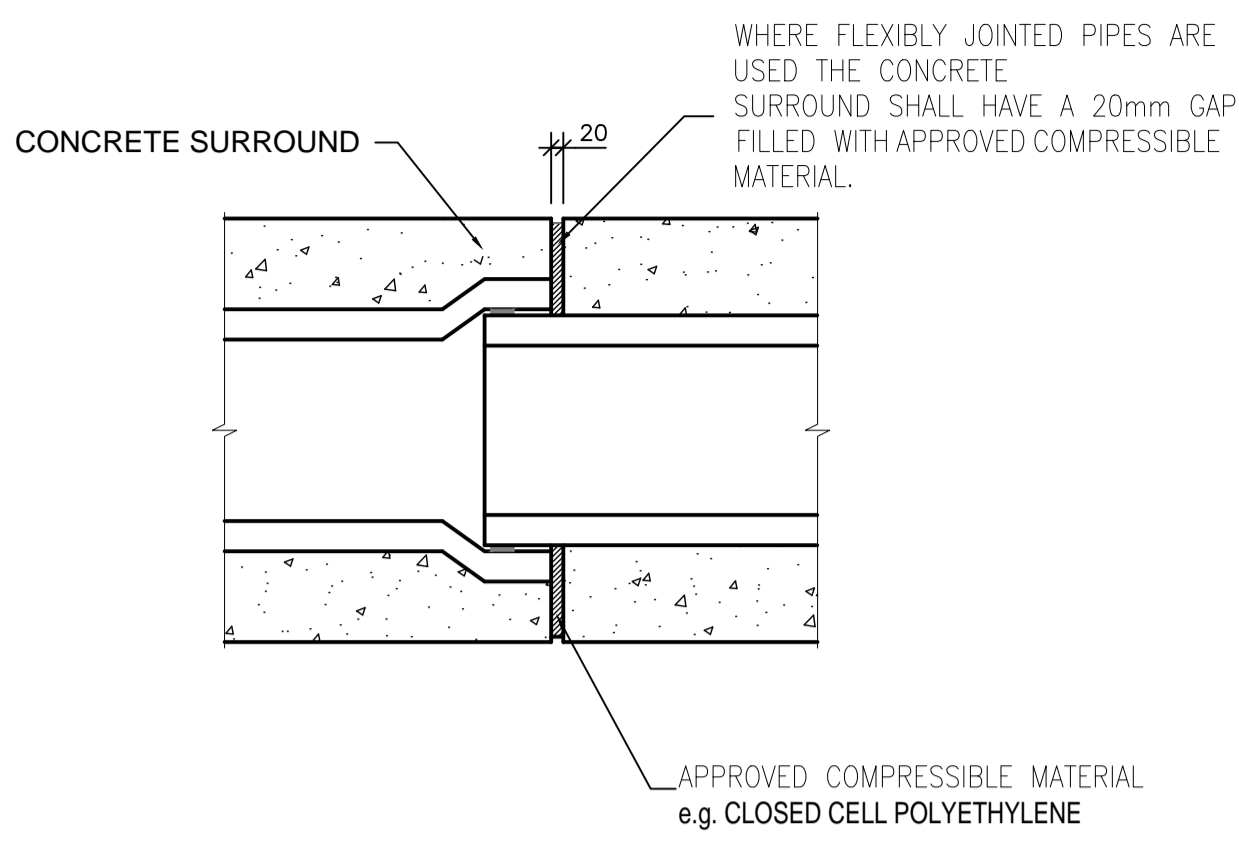

JOINT IN CONCRETE SURROUND

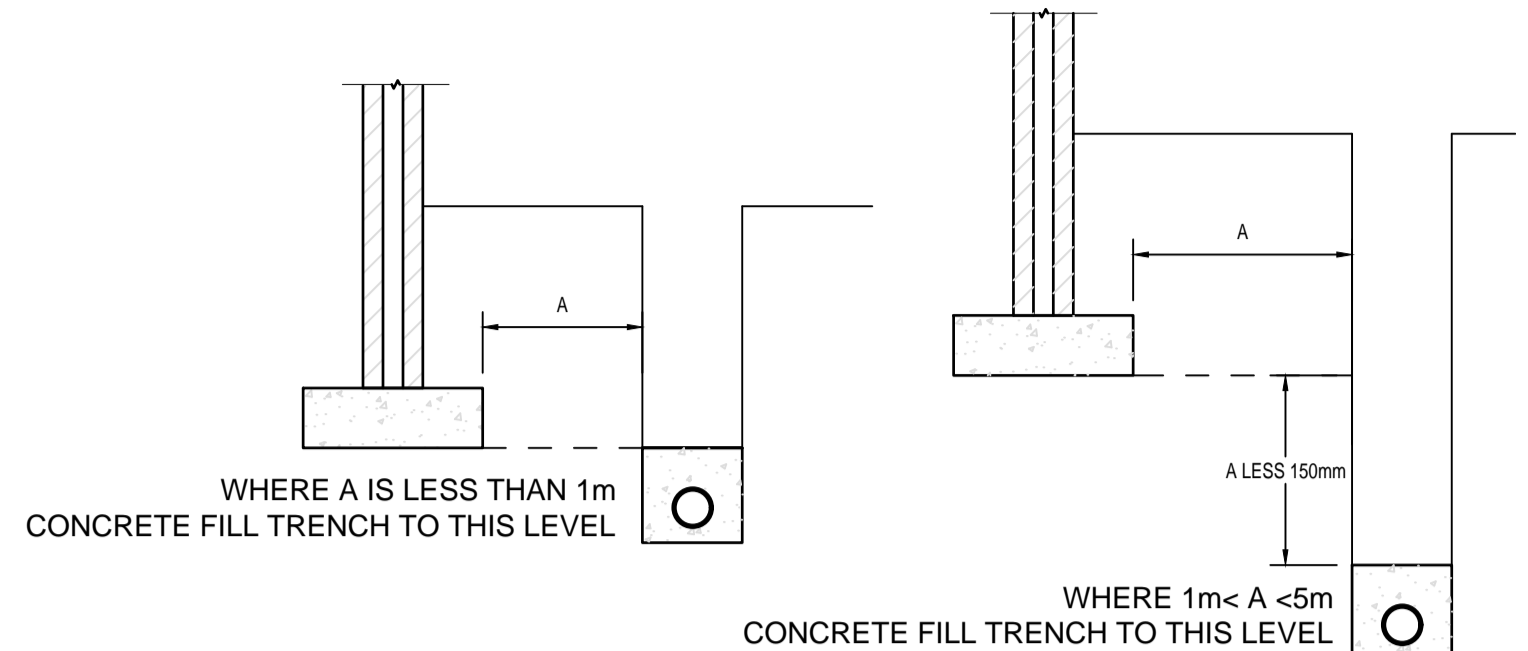

CONCRETE SURROUND TO PIPE RUN NEAR BUILDINGS / FOUNDATIONS

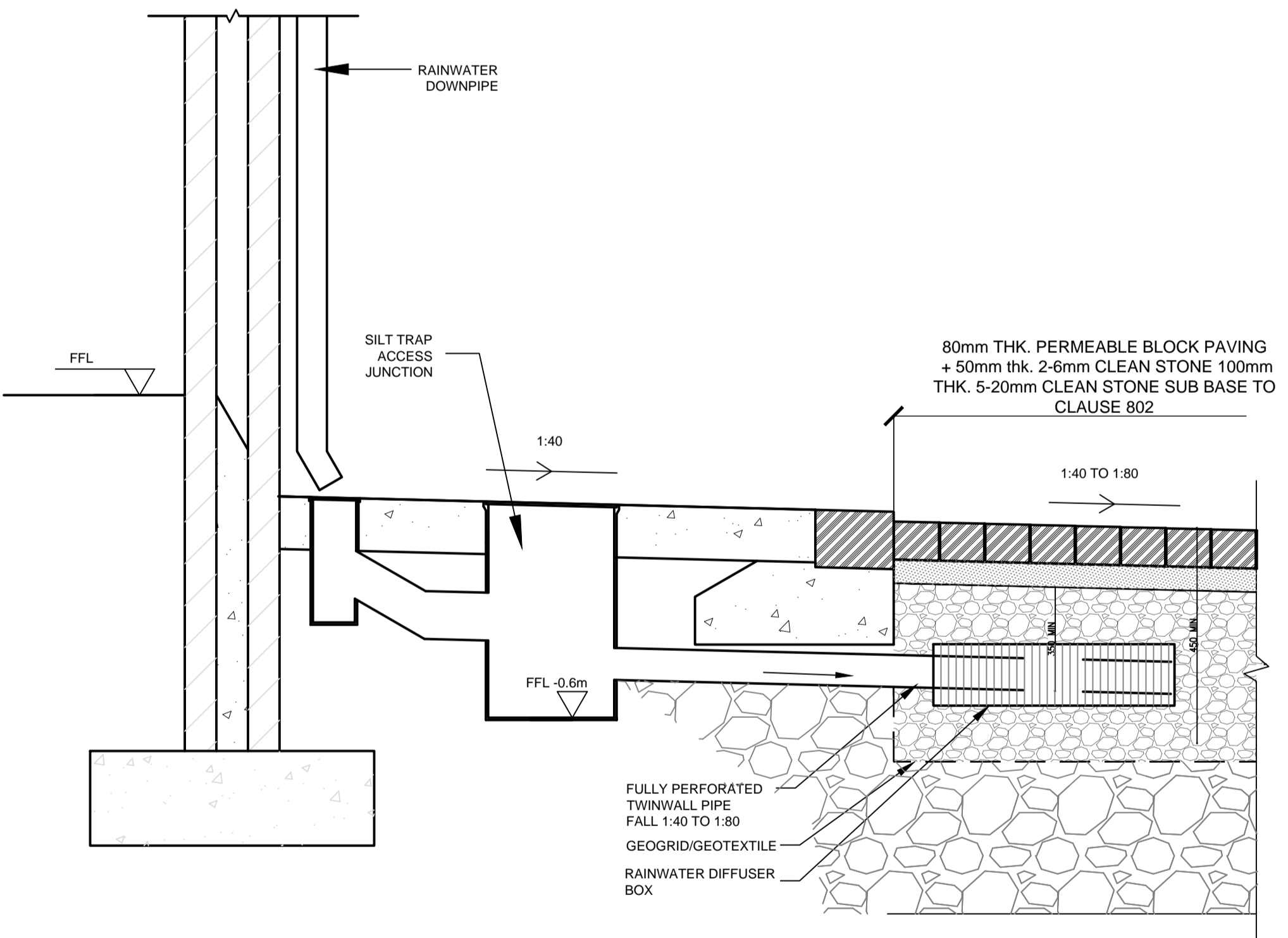

PAVEMENT DRAINAGE DETAILS
Scale at A1 1:10
Scale at A3 1:20

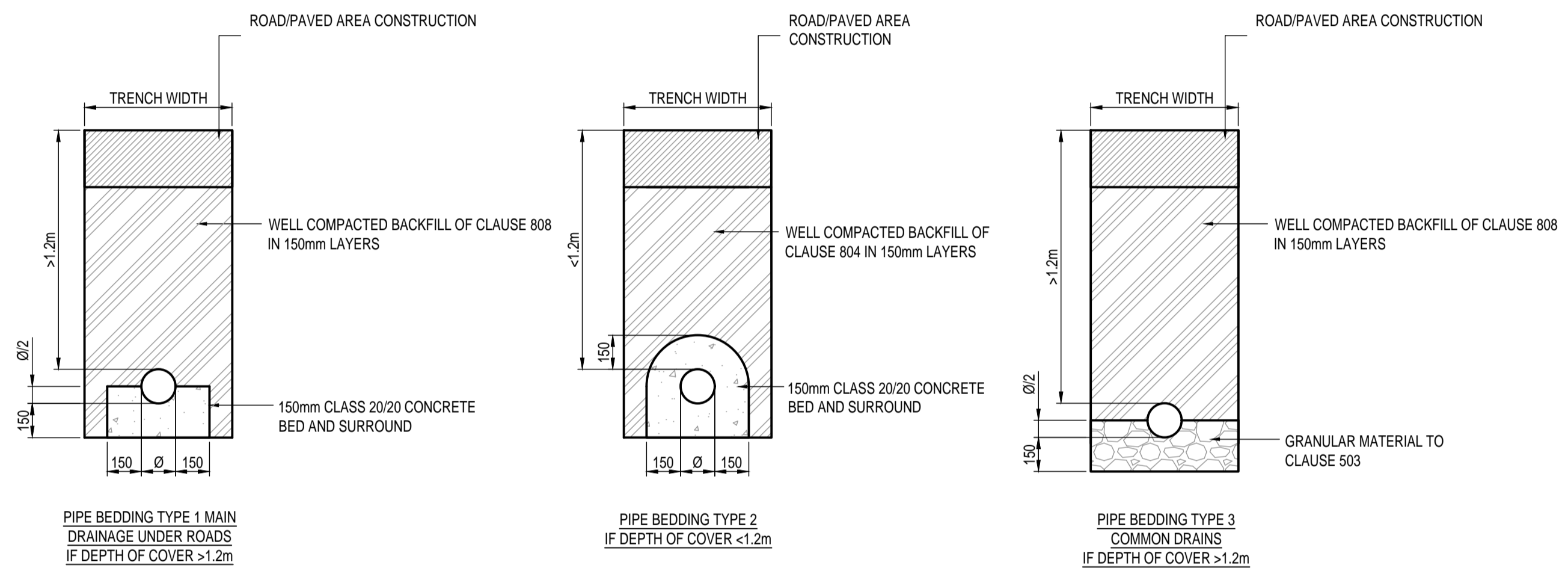
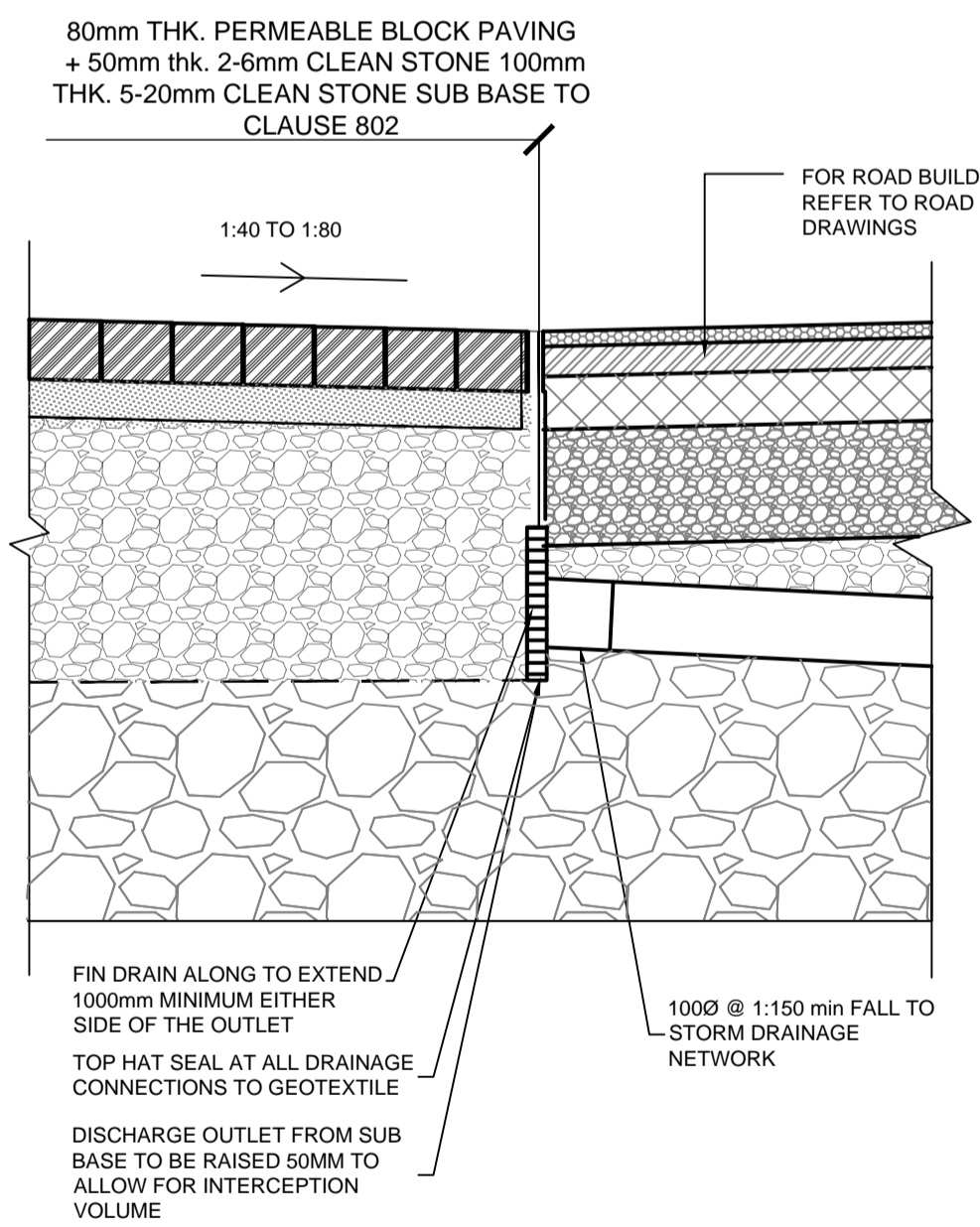

SURFACE WATER PIPE BEDDING DETAILS

Scale at A1 1:20
Scale at A3 1:40

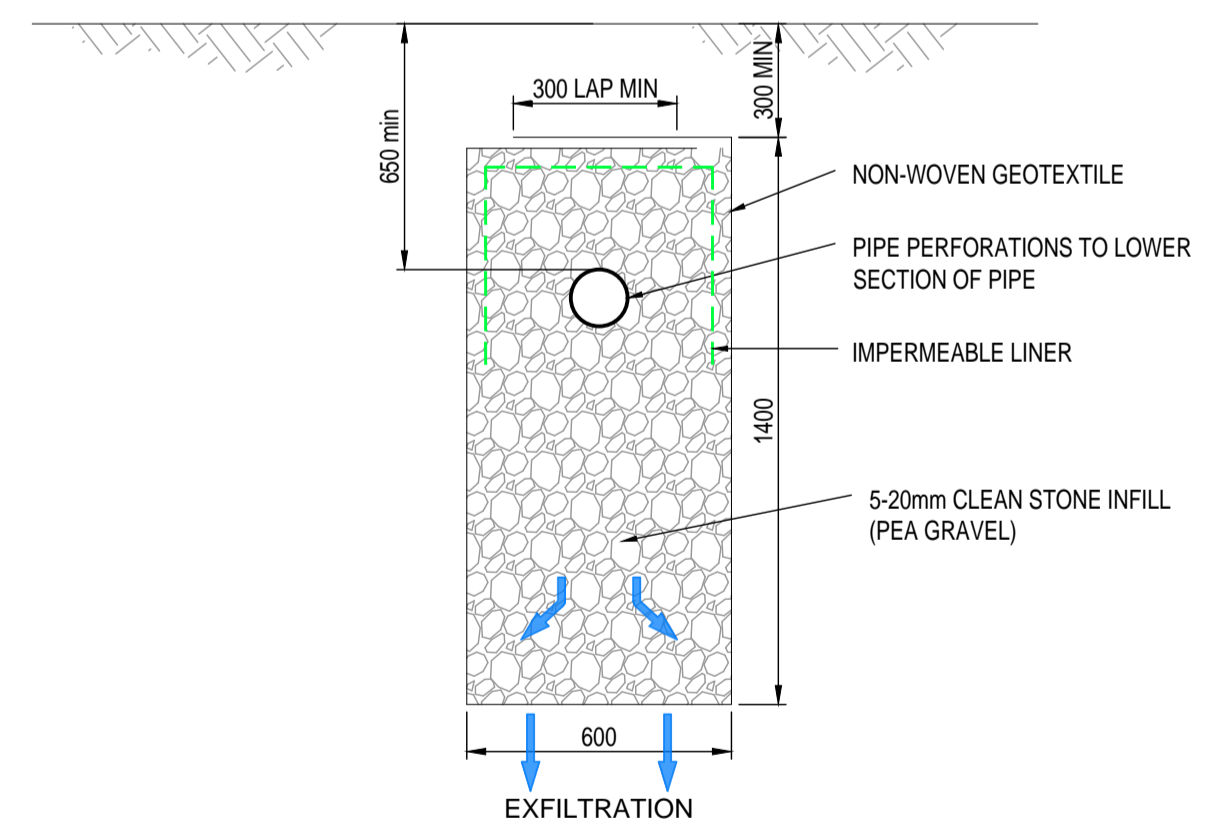

TYPICAL FILTER DRAIN DETAIL

Scale at A1 1:20
Scale at A3 1:40

© ORDNANCE SURVEY IRELAND LICENSE No. AR 0082525. ORDNANCE SURVEY IRELAND & GOVERNMENT OF IRELAND

Rev	Description	By	Date	Chk'd	Auth
P01	ISSUED FOR PLANNING	PS	06.09.22	AC	GH



DUBLIN | CORK | GALWAY | DUNDALK

ATKINS HOUSE, 150 AIRSIDE BUSINESS PARK, SWORDS, DUBLIN, K67 K5W4.
Tel : +353 1 810 8000 Email : info.ie@atkinsrealis.com

Atkins House, 150-155 Airside Business Park, Swords, Co. Dublin
Unit 2B, 2200 Cork Airport Business Park, Cork
1st Floor Technology House Parkmore Technology Park, Galway
Tel (+353) 01 810 8000 Tel (+353) 021 429 0300 Tel (+353) 091 786 050
Fax (+353) 01 810 8001 Fax (+353) 021 429 0360 Fax (+353) 091 779 830

Client	SHANKILL PROPERTY INVESTMENTS LTD		
Project	SEA GARDENS PHASE 1 BLOCK A		

Purpose	PLANNING						
Title	STANDARD CONSTRUCTION DETAILS SHEET 2 of 3						
Original Scale	AS	Design/Drawn	PS	Checked	AC	Authorized	GH
Date	26.05.22	Date	26.05.22	Date	26.05.22	Date	26.05.22
Status	P	Drawing Number	5214419-ATK-ZZ-ZZ-SK-SD-0002	Rev	P01		